

Super Windmaster FANS

DCA SERIES (ALUMINUM)

- All aluminum construction
- Six-bladed propeller utilizing a cambered - twist blade design with a unique dihedral tip for higher air flow capacities at less horsepower.
- Non-overloading design maintains horsepower within catalog range of static pressure, resulting in lower motor load and reduced operating costs.
- Streamlined orifice insures higher air flow capacity.
- Available mounted in either slant or square wall housing.

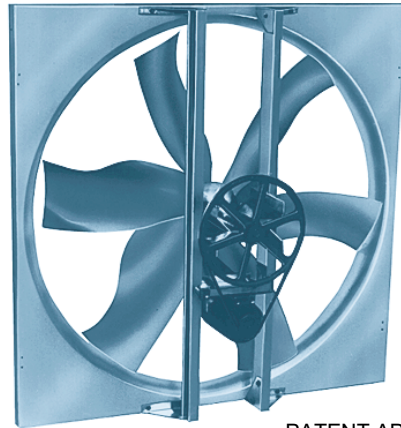

PATENT APPLIED FOR



Acme Engineering and Manufacturing Corporation certifies that the Super Windmaster DCA as shown herein is licensed to bear the AMCA Seal. The ratings shown are based on tests and procedures performed in accordance with AMCA Publication 211 and comply with the requirements of the AMCA Certified Ratings Program.

SEALED BEARINGS

- Prelubricated oversize ball bearings are double sealed, require no service.
- Improved, more efficient drive assembly and super-duty neoprene belts provide longer service life.

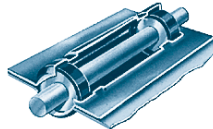

ENERGY EFFICIENT ENCLOSED MOTORS

- Heavy duty totally enclosed motors with shielded ball bearings are designed for continuous work load.
- Available in two speed.
- Built-in thermal overload for low-line voltage protection on all single phase motors.



MOTOR NOTES

1. All single speed single phase motors are dual voltage (115/230) except ¼ horsepower.
2. All ¼ horsepower single phase motors are single voltage (115 or 230).
3. Two-speed motors are single voltage (115 or 230) and not available in 1½ horsepower.
4. Low speed capacity of two speed fans is approximately one half of maximum.
5. All three phase motors are triple voltage (200-230/460).

FAN	HP	RPM	CERTIFIED CFM VS. STATIC PRESSURE (INCHES WG)															MAX STATIC PRESSURE
			.000"			.050"			.100"			.125"			.150"			
			CFM	*BHP	C/W	CFM	*BHP	C/W	CFM	*BHP	C/W	CFM	*BHP	C/W	CFM	*BHP	C/W	
DCA24E	¼	622	4900	.28	15.3	4580	.28	14.3	4185	.29	12.6	3880	.29	11.7	-	-	-	.125
DCA24F	⅓	735	5830	.46	12.1	5555	.47	11.3	5235	.47	10.6	5035	.48	10.0	4776	.48	9.5	.150
DCA24G	½	820	6490	.61	10.9	6290	.64	10.1	6065	.66	9.4	5940	.66	9.2	5785	.67	8.8	.200
DCA24G-2S	½	763	6040	.50	10.2	5820	.52	9.5	5575	.53	8.9	5420	.54	8.5	5220	.54	8.2	.150
DCA24H	¾	949	7400	.93	8.3	7195	.94	7.9	6985	.95	7.6	6875	.95	7.5	6760	.96	7.3	.300
DCA24H-2S	¾	875	6820	.73	8.4	6600	.74	8.0	6365	.75	7.6	6245	.75	7.5	6115	.76	7.2	.250
DCA30F	⅓	529	8185	.34	23.0	7750	.35	21.1	7225	.36	19.2	6870	.37	17.7	6430	.37	16.6	.200
DCA30G	½	607	9375	.66	14.5	8990	.67	13.7	8580	.69	12.7	8340	.70	12.2	8065	.70	11.8	.250
DCA30G-2S	½	546	8430	.48	14.8	8005	.49	13.8	7515	.51	12.4	7210	.51	11.9	6820	.52	11.1	.200
DCA30H	¾	686	10620	.96	11.5	10285	.98	10.9	9940	.99	10.4	9750	1.00	10.1	9550	1.01	9.8	.300
DCA30H-2S	¾	647	10015	.81	11.1	9660	.82	10.6	9290	.84	9.9	9080	.85	9.6	8855	.85	9.4	.250
DCA36F	⅓	431	10005	.32	29.9	9345	.34	26.2	8555	.39	20.9	8035	.38	20.2	7330	.32	21.9	.150
DCA36G	½	495	11585	.51	23.2	11065	.53	21.4	10475	.55	19.5	10110	.56	18.5	9670	.58	17.1	.200
DCA36G-2S	½	463	10730	.38	23.9	10055	.41	20.7	9310	.44	17.9	8880	.45	16.7	8685	.46	15.4	.200
DCA36H	¾	575	13325	.73	18.9	12785	.77	17.2	12225	.81	15.7	11930	.83	14.9	11615	.84	14.4	.300
DCA36H-2S	¾	511	11845	.51	20.9	11235	.55	18.4	10585	.58	16.4	10225	.59	15.6	9835	.61	14.5	.200
DCA36J†	1	634	14560	.99	15.3	14175	1.03	14.3	13775	1.07	13.4	13560	1.09	12.9	13325	1.10	12.6	.375
DCA42G	½	385	14690	.58	25.9	13635	.62	22.5	12465	.65	19.6	11775	.66	18.3	10920	.66	16.9	.200
DCA42G-2S	½	356	13585	.46	25.0	12435	.49	21.4	11105	.52	18.0	10235	.52	16.6	8970	.53	14.3	.150
DCA42H	¾	442	16710	.83	20.9	15940	.85	19.5	15190	.90	17.5	14725	.92	16.6	14165	.93	15.8	.250
DCA42H-2S	¾	511	15615	.68	20.6	14800	.70	29.0	13950	.74	16.9	13385	.76	15.8	12700	.76	15.0	.200
DCA42J†	1	485	18295	1.11	17.1	17620	1.14	16.1	16980	1.19	14.8	16575	1.20	14.7	16125	1.20	14.0	.250
DCA48G	½	308	17490	.54	33.1	16215	.56	29.6	14495	.59	25.1	13420	.61	22.5	12005	.63	19.5	.150
DCA48G-2S	½	276	15675	.39	34.0	14215	.41	29.3	12045	.44	23.1	10190	.45	19.1	-	-	.125	
DCA48H	¾	354	19775	.79	26.0	18825	.82	23.8	17625	.85	21.5	16770	.87	20.0	15770	.90	18.2	.200
DCA48H-2S	¾	314	17540	.55	28.7	16445	.56	25.5	14805	.61	21.8	13675	.63	19.5	12415	.64	17.4	.150
DCA48J†	1	382	21380	.98	22.7	20440	1.01	21.0	19420	1.05	19.2	18830	1.06	18.5	18130	1.08	17.4	.250
†DCA54-4J†	1	356	25570	1.15	23.1	23870	1.17	21.2	21920	1.19	19.1	20790	1.20	18.0	19600	1.21	16.8	.150
†DCA54-4K	1½	405	29090	1.69	18.2	27610	1.72	17.0	26000	1.74	15.8	25110	1.75	15.2	24130	1.76	14.5	.200

- ‡ Available with two-speed motor in 230/1 only. Performance shown is installation of type A-Free inlet. Free outlet.
- * Power ratings (BHP) does not include drive losses. Performance ratings do not include the effects of appurtenances in the airstream.
- † These models feature a four-bladed propeller

CFM per Watt does not include drive losses. C/W ratings are not licensed to bear the AMCA seal.

WARNING! DO NOT use in HAZARDOUS ENVIRONMENTS where fan's electrical system could provide ignition to combustible or flammable materials unless unit is specifically built for hazardous environments.

CAUTION! Guards are strongly recommended when the fan is installed within seven (7) feet of the floor, working level or within reach of personnel. Guards complying with OSHA regulations are available as optional equipment. Review OSHA Codes and obtain a quotation.



BELT TIGHTENERS FOR DCA SERIES:

Keep fan performance to the design level, maintaining efficiency.

Not available for DCA24 and RCA24 models.